

A025L24H105-1

Features

- Wide range **90 ~ 277VAC** (normal) input voltages with **Constant Current** output, suitable for remote locations.
- Fully encapsulated with **IP65** level compliant, suitable for damp or wet locations.
- Reliability **Protections**: short circuit/over current/over voltage/over temperature
- High **Efficiency**, low heat generated. Cooling by convection air.
- 100% full load QC burn-in test
- High reliability/ **low cost**
- One-year warranty



Order Information

X XXX X XX X XXX - X

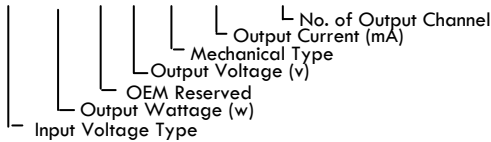

Application – Street / Architecture LED Lighting



Specifications

MODEL No.	A025L24H105-1	
OUTPUT	DC VOLTAGE Rated / Rage	24 / 12 ~ 24V
	RATED CURRENT	1050mA
	CURRENT RANGE	0 ~ 1050mA
	RATED POWER	25W
	RIPPLE & NOISE (max.) note.2	120mVp-p
	VOLTAGE TOLERANCE note.3	± 3.0%
	LINE REGULATION	± 1.0%
	LOAD REGULATION	± 2.0%
SETUP, RISE TIME	1500ms, 30ms/115VAC	
INPUT	VOLTAGE RANGE	85 ~ 305VAC (Max.) , 90 ~ 277VAC (Normal)
	FREQUENCY RANGE	47 ~ 63Hz
	EFFICIENCY(Typ.)	84%
	AC CURRENT	0.5A/115VAC
	INRUSH CURRENT(Max.)	cold start 40A/115VAC
	LEAKAGE CURRENT	0.25mA/115VAC
PROTECTION	OVER CURRENT	ABOVE 120% rated output power Protection Type: Hiccup mode, recovers automatically after fault condition is removed.
	OVER VOLTAGE	Protection Type: Shut off o/p voltage, clamping by zener diode
	OVER TEMPERATURE	95°C typically (U1) detect on main control IC Protection type: Shut down, recovers automatically after temperature drop below 63°C
ENVIRONMENT	WORKING TEMP.	-25 ~ 70°C (Refer to output load derating curve)
	WORKING HUMIDITY	20 ~ 90% RH non-condensing
	STORAGE TEMP., HUMIDITY	-40 ~ +80°C, 10 ~ 95% RH
	TEMP. COEFFICIENT	± 0.03%/°C (0~ 50°C)
VIBRATION	10 ~ 500Hz. 2G 10 min./1 cycle, period for 60 min. each along X,Y,Z axes	
SAFETY & EMC	SAFETY STANDARDS	Design refer to UL1310 Class 2, TUV EN60950-1, EN61347-2-13, CAN/CSA, IP65 approved
	WITHSTAND VOLTAGE	I/P-O/P:3750VAC
	ISOLATION RESISTANCE	I/P-O/P:>100M Ohms / 500VDC / 25°C / 70%RH
	EMI CONDUCTION & RADIATION	Compliance to EN55015, FCC,47 CFR, Part 15, class B
	HARMONIC CURRENT	Compliance to EN61000-3-2,-3
FMS IMMUNITY	Compliance to EN61000-4-2,3,4,5,6,8,11	
OTHERS	MTBF	100Khrs min. MIL-STD-K217F(25°C)
	DIMENSION (R x H)	40 x 26.6 (mm)
	PACKING	0.175KG; 70 pcs /13.3Kgs / 0.66CUFT
NOTE	1. All parameters NOT specially mentioned are measured at 115VAC input, rated load and 25°C of ambient temperature.	
	2. Ripple & noise are measured at 20 MHz of bandwidth by using a 12" twisted pair-wire terminated with a 0.1uf & 47uf parallel capacitor.	
	3. Tolerance: includes set up tolerance, line regulation and load regulation.	
	4. The power supply is considered a component which will be installed a final equipment. The final equipment must be re-confirmed that is still meets EMC directive.	

LED Lighting Driver

Mechanical Drawing

Unit: mm

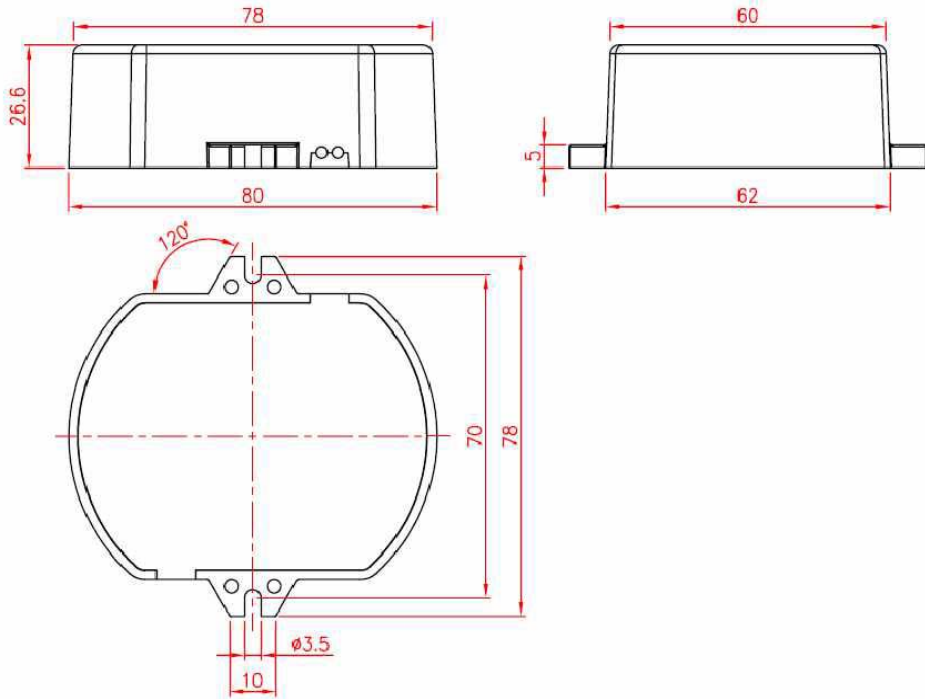

Notes

- Specification subject to change without notice.
- All company logo and legal name belong to original company. All copyright reserved by Enhance Electronics.
- One-Year Standard Warranty
- Last Update: 2009/10/9